

2002 South Bob O' Link Lane, Palm Springs, CA 92264

3 Beds 2 Baths 1,648 Sq Ft

\$1,125,000

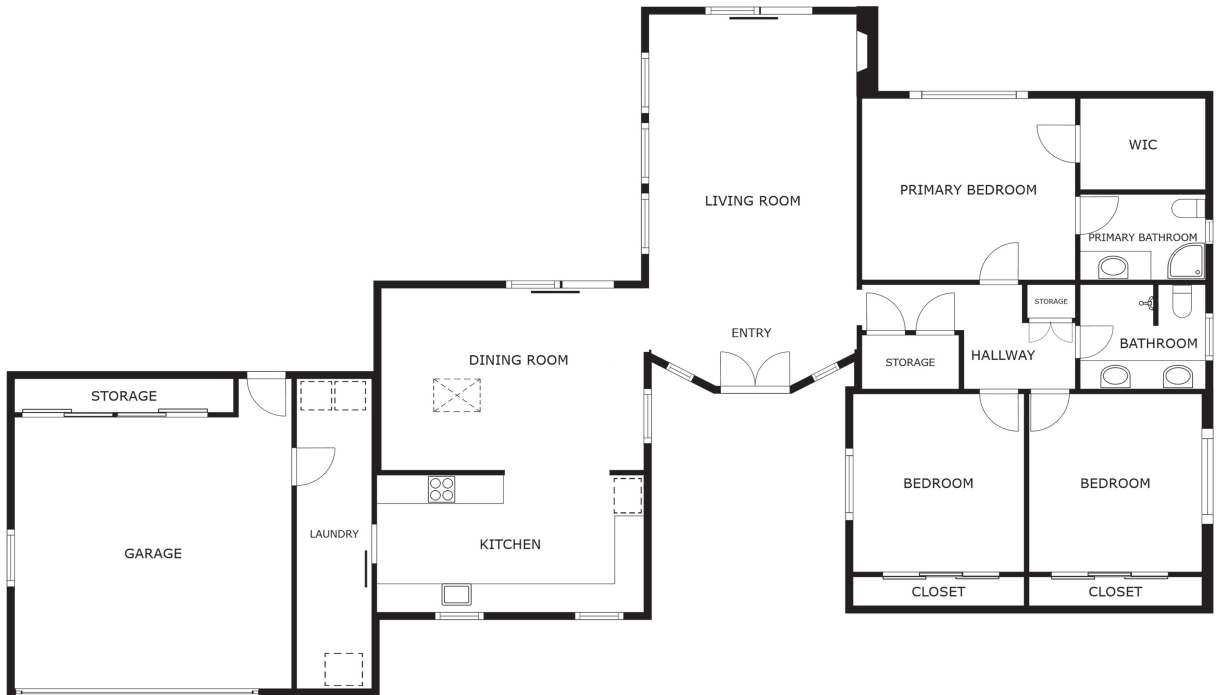

FLOOR PLAN



DWELLING™ | REAL ESTATE

Robert Cipolloni
DWELLING™ | REAL ESTATE

CEO, President and Broker
Los Angeles Metro & Greater Palm Springs

E: robert@dwellingre.com
C: 760-285-6161
CalRE# 01458843